



MUSÉE DE L'HISTOIRE
DE L'IMMIGRATION

NEW PERMANENT EXHIBITION



PALAIS DE LA PORTE DORÉE

NATIONAL MUSEUM OF THE HISTORY OF IMMIGRATION | TROPICAL AQUARIUM

293 avenue Daumesnil - 75012 Paris | www.palais-portedoree.fr



THE NEW PERMANENT EXHIBITION



Since its opening in 2007, the National Museum of the History of Immigration has forged a unique place in the french cultural landscape. Located in the Palais de la Porte Dorée, a monumental Art Deco masterpiece built to celebrate colonialism, its aim is to be a museum of history, society and art. Studying the past to shed light on the present, reminding visitors of the long history and diversity of migration in France, calmly participating in ongoing debates in French society on immigrants and migrants of the past and present... These are the missions of the National Museum of the History of Immigration.

To explore our history in greater depth, decipher current events in more detail and broaden perspectives to encompass the international dimension of migrations, the Museum's permanent exhibition is undergoing a thorough redesign. Due to reopen in the spring of 2023, it will be bigger with a completely new and more accessible approach and scenography.



View of the future 1889 and 1917 focus sections in the new permanent exhibition.



NEW APPROACH, NEW EXHIBITION

A HISTORICAL APPROACH COVERING THREE CENTURIES

Using the latest historiographical advances, the National Museum of the History of Immigration has come to the fore as a major museum of French history. It will offer a better understanding for all audiences and strengthen ties with teaching programmes, from primary level to higher education. It will offer a detailed and sensitive immersion into more than three centuries of immigration history and will also focus on modern times.

The exhibition will be structured around eleven chronological focus sections based on key dates, from 1685 to the present day. It will discuss the condition of foreigners under the Ancien Régime, their role during the wars, major migratory movements, colonisation and decolonisation, the fight for rights and changes in the reception of foreigners.

Each section will highlight major events from the period and include thematic focus points, combining political, cultural and social history. The Museum's collections (contemporary art, photographs, archive documents and everyday objects from the past) will be showcased and complemented by deposits from other public institutions. The exhibition will also be enriched with archive exhibits, audiovisual works and digital devices.



Robert Capa, *On the road from Barcelona to the French border*, January 1939 © MNHI, Robert Capa/Magnum Photos.



View of the future 1983
focus and the Mosaic
Room in the new permanent
exhibition.



VISITORS AT THE HEART OF THE PROJECT

Accessibility and the visitor experience for groups have guided reflection on the exhibition's scenography. Our aim is to offer a stimulating experience of historical and cultural discovery of France for all, through a variety of new mediation tools:

- Extensive use of digital technology: visitors will find multimedia stations with animated films on legal changes and animated maps. Several spaces will also be dedicated to mediation and specific visit aids (translations, audio description, French sign language videos, texts in easy French, children's visits, thematic visits, etc.) will be available to download from a digital kiosk. A digital presentation of the exhibition will also be designed for the "Palais Porte Dorée" app.
- A "cinema" visit: excerpts from fiction films will punctuate the route.
- "Rooms" dedicated to music and audiovisual archives.
- Additional content available online and indicated in the exhibition.
- Translation into several languages: in addition to translating the main texts into English in the scenography, the Museum wishes to provide a full translation of all the texts into as many languages as possible, available via a digital tool. This project will allow the National Museum to offer the same level of experience for all and demonstrate the warm welcome it extends to those joining or who have joined French society.
- Regular mediation activities.
- 80 seats for resting during the visit.

To discuss these issues as widely as possible, especially internationally, the new exhibition will also be available as a travelling exhibition. Additional modules will allow partners to tell the story of migration in their territories or countries.

HARMONIOUS SCENOGRAPHY IN A FULLY RENOVATED SPACE

The exhibition space will be increased to cover a total area of 1,700m². It will be completely renovated, refurbished and air-conditioned to protect the works and offer the best visit conditions for all visitors and groups. The new exhibition route will be well-structured, harmonious and varied.



View of the future 1789 focus in the new permanent exhibition.



Modular scenography will allow content to be rotated and works to be presented from the Museum's three collections. It will offer a strong and coherent visual identity.

It will be chronological, engaged, educational and sensitive with:

- An introductory space to present the main topics of the exhibition and key elements with animated maps.
- A unique atmosphere in each space dedicated to the eleven key dates.
- An immersive corridor to mark the transition from the late 1980s to the space on contemporary issues. Visitors will pass through a series of images evoking key moments in the 1990s and 2000s and new population flows.
- The space dedicated to the contemporary period will address the migration "crisis" in 2015 as well as multiculturalism, discrimination and relegation in France, welcome and hospitality.

THE PLAN

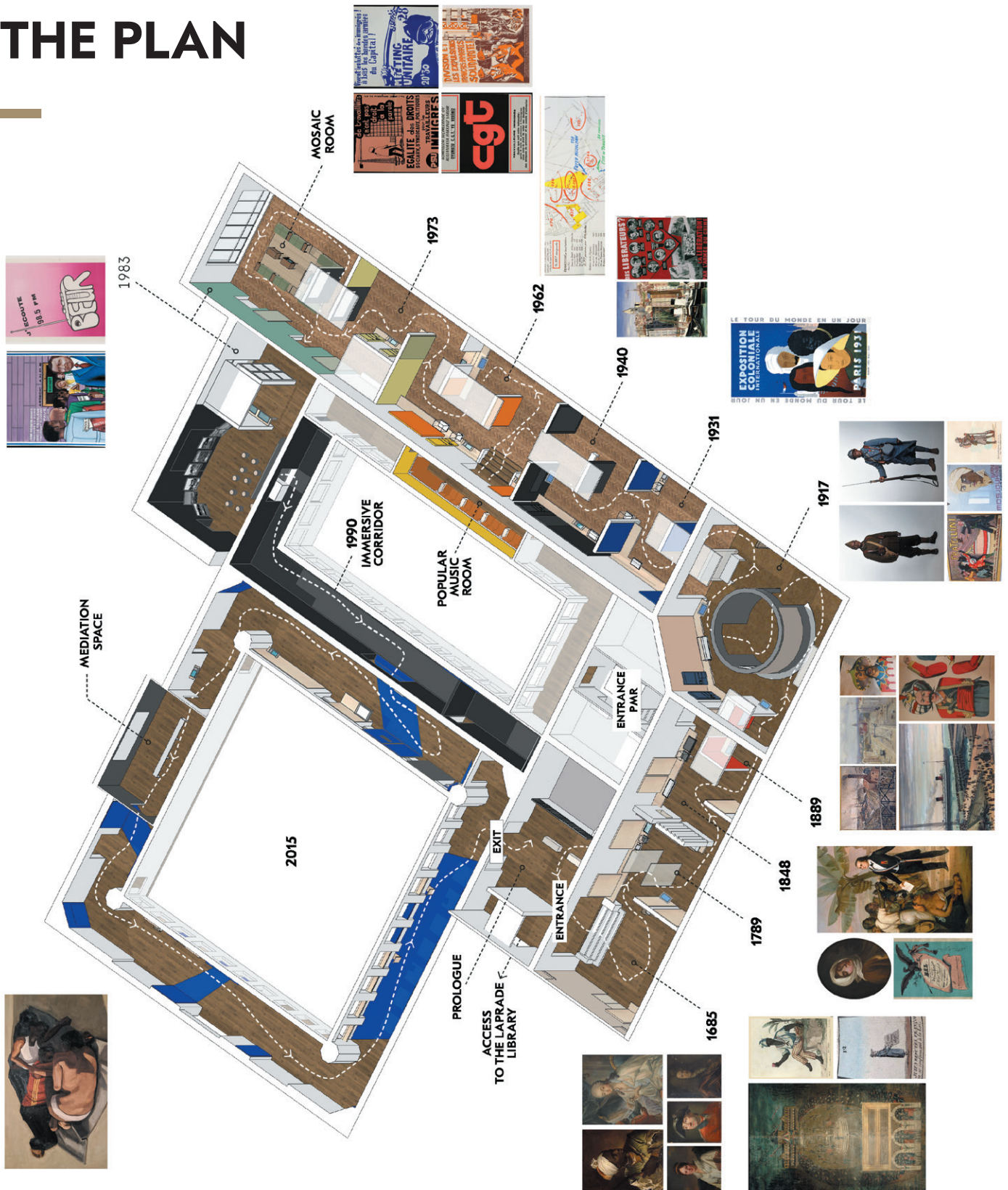

THE NEW EXHIBITION IN FIGURES

**1 MILLION VISITORS SINCE THE MUSEUM
OPENED** in the Palais de la Porte Dorée in 2007.

THE MUSEUM'S THREE COLLECTIONS

History (archives, press articles and drawings, photographs), Contemporary Art (Barthélémy Toguo, Kader Attia, Chen Zhen, Bouchra Khalili etc.) and Society (objects, documents, testimonies from the lives of migrants or their descendants).

**11 "KEY" DATES THROUGH CENTURIES
OF MIGRATION IN FRANCE,** from 1685 to 2015.

Some dates are well known, others less so, but all played a pivotal role in major historical periods.

75 PEOPLE INVOLVED IN DESIGNING THE NEW PERMANENT EXHIBITION

Sixty scientists (historians, geographers, sociologists, political scientists, curators, etc.) contributed to the preliminary report for the new exhibition, led by Patrick Boucheron, and fifteen specialists are now working on its design and creation.

670 ITEMS PRESENTED IN THE NEW EXHIBITION

including works of art, objects, printed documents and audiovisual and multimedia content. Mainly from the Museum's collections, they are complemented by loans and deposits from major institutions.

1,700 M² OF SPACE FOR THE NEW PERMANENT EXHIBITION

€3 MILLION BUDGET

ALONGSIDE THE COLLECTIONS

THE MUSEUM IS ALSO:



- Two major exhibitions per year.
- Events throughout the year: festivals, shows, concerts, screenings, debates on current issues.
- Membership and participation in international networks and museums (Migration Museums Network, Association of European Migration Institutions, International Coalition of Sites of Conscience).
- Framework partnerships with: associations (Médecins sans frontières, Emmaüs Solidarité, France Terre d'asile, Cimade), institutions (French Institute, the French Ministry for Europe and Foreign Affairs, Agence Française de Développement, the French Economic, Social and Environmental Council) and local authorities.
- Travelling exhibitions held throughout the country, especially for young people under 25 (45% of the audiences reached) and people far from cultural institutions.
- 195 off-site mediation activities a year for 65,000 visitors.
- 1200 teachers trained each year.
- A Literary Prize awarded for the past twelve years to a French-language work on exile, migration, plural identities and otherness.
- *Hommes & Migrations*, the quarterly social science journal published by the Museum.
- Resources published online in full by 2023.
- A new website in March 2022.